



17 Locksley Street Wendouree VIC

4 1 1

Positioned in the increasingly popular suburb of Wendouree and in close proximity to the Ballarat CBD, Lake Wendouree, Stockland Shopping Centre, Train Station and schools sits this brick home. Internally, this property features four bedrooms, all of which are spacious with built in robes, a large lounge area which enjoys plenty of natural light, open plan dining and kitchen area with a generous amount of cupboard and bench space. Down the hall you will find a main bathroom with vanity, shower and bath as well as a laundry with a separate toilet. Externally this property is equally impressive on a generous allotment with a large enclosed yard, back yard access through lock up gates and a large single lock up garage. Other features of this property include, gas central heating, split system cooling and brilliant renters already in place until July 2022. This ...

Price : \$ 470,000

View : <https://www.ballaratrealestate.com.au/sale/vic/ballarat-western-district/wendouree/residential/house/6839677>

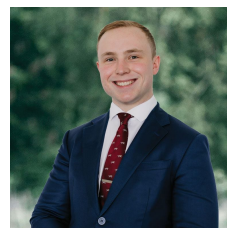

Lachlan Sylvia
03 53312233
0458 068 234

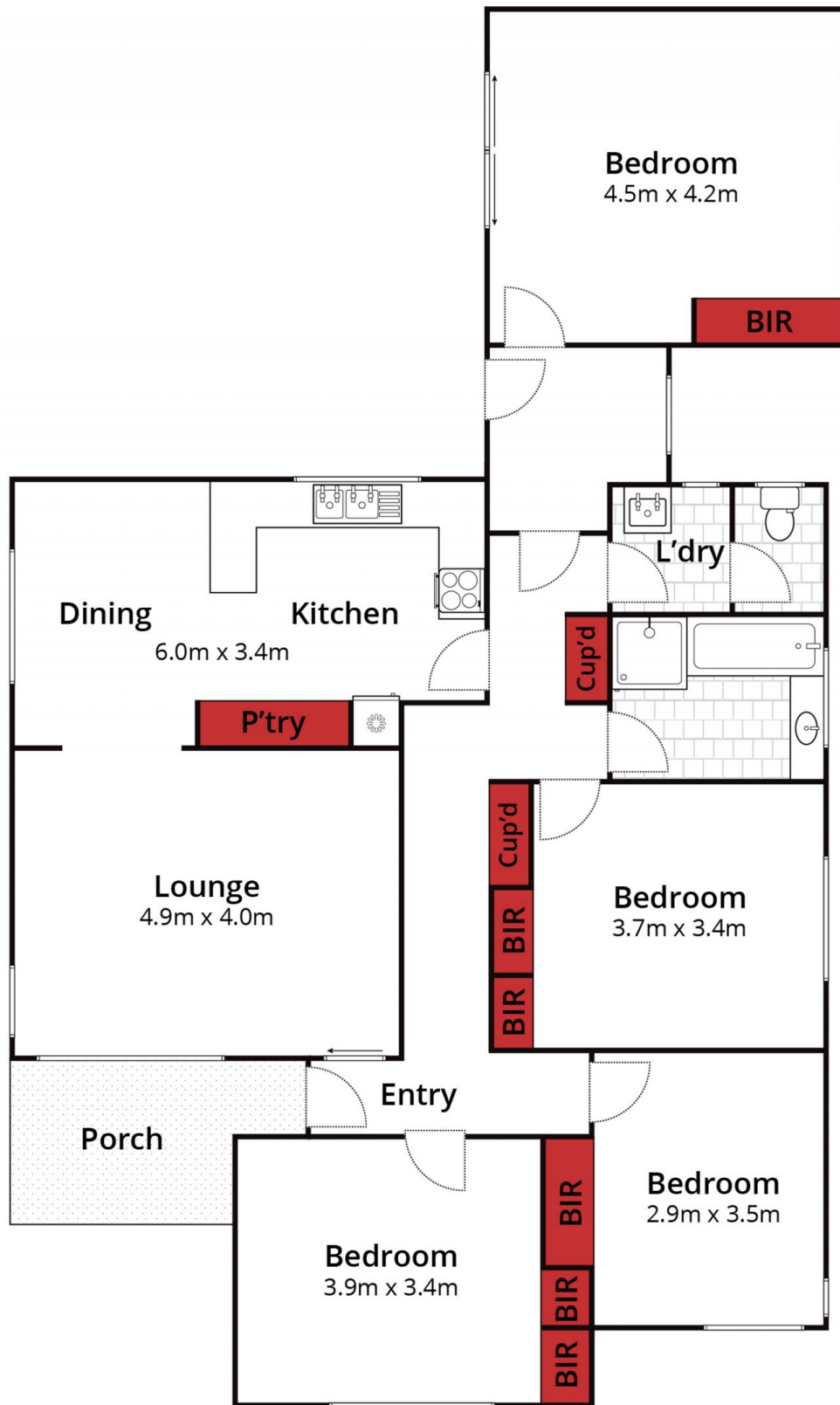

Approx House Area 133m² 4 1 0

Whilst bwrn.com.au has made every attempt to ensure the accuracy of the floor plan contained here, measurements are approximate and no responsibility is taken for any error, omission, or mis-statement. This plan is for illustrative purposes only.

17 Locksley Street, Wendouree

