



9 Shelley Street Wendouree VIC

3 1 3

Positioned on a generous block of around 663m² (approx) in the golden square of Wendouree close to Lake Wendouree, Mars Stadium, Howitt Street shopping and Ballarat Grammar. This location has it all with everything you need at your fingertips while remaining in a nice quiet street. Inside the home you will find polished timber floorboards, feature cornices and updated kitchen. The home consists of three well sized bedrooms all equipped with built in robes, an updated open plan kitchen/dining with adjacent walk in store room, a large living area, family bathroom and also a full laundry. The house is serviced by gas central heating providing warmth in the colder months as well as a split system for both heating and cooling. Outside you will find an undercover wooden deck area providing a great entertaining space overlooking the rear yard as well as a large bun ...

Price : \$ 555,000
Land Size : 663 sqm
View : <https://www.ballaratrealestate.com.au/sale/vic/ballarat-western-district/wendouree/residential/house/7109411>



Dominic Morrison
5331 2233
0409 557 461



Mitchell Burgess
03 5331 2233
0458019897

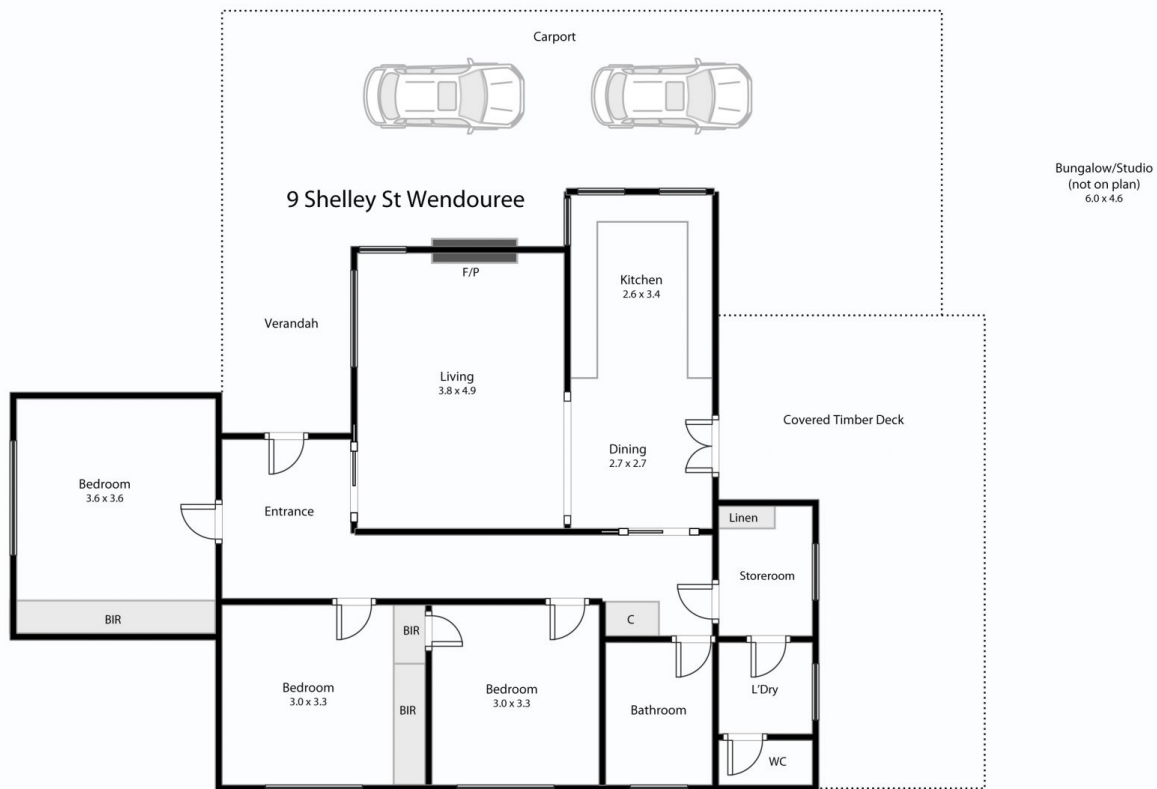

This plan is for illustrative purposes only, floor plan proportions and scale are approximate. Plan prepared by PLP Ballarat © 2022 for Ballarat Real Estate.



Contact: Dominic Morrison 0409557461