



4 Conan Street Wendouree VIC

3 1 2

Positioned on a large block of around 723m² (approx) in popular Wendouree close to the Lake, Mars Stadium, Stockland Shopping Centre and Ballarat Grammar is this attractive home. Everything you need is close by whilst benefiting from a nice quiet street. Internally you will find a spacious open plan living/ meals area filled with natural light. The renovated kitchen with timber benchtops glass electric cooktop and plenty of storage is a delight. The home consists of three generous sized bedrooms, two with built in robes. The central family bathroom has been beautifully renovated with a walk-in shower and freestanding bath and double vanity. The house is serviced by a wood heater providing warmth in the colder months as well as a split system for both heating and cooling. You will be impressed by the outdoor area with fire pit and the large shedding with ple ...

Price : \$ 470,000
Land Size : 723 sqm
View : <https://www.ballaratrealestate.com.au/sale/vic/ballarat-western-district/wendouree/residential/house/7123673>

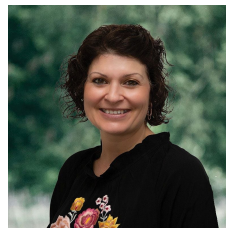

Tash Guinea
03 53312233
0439 831 058

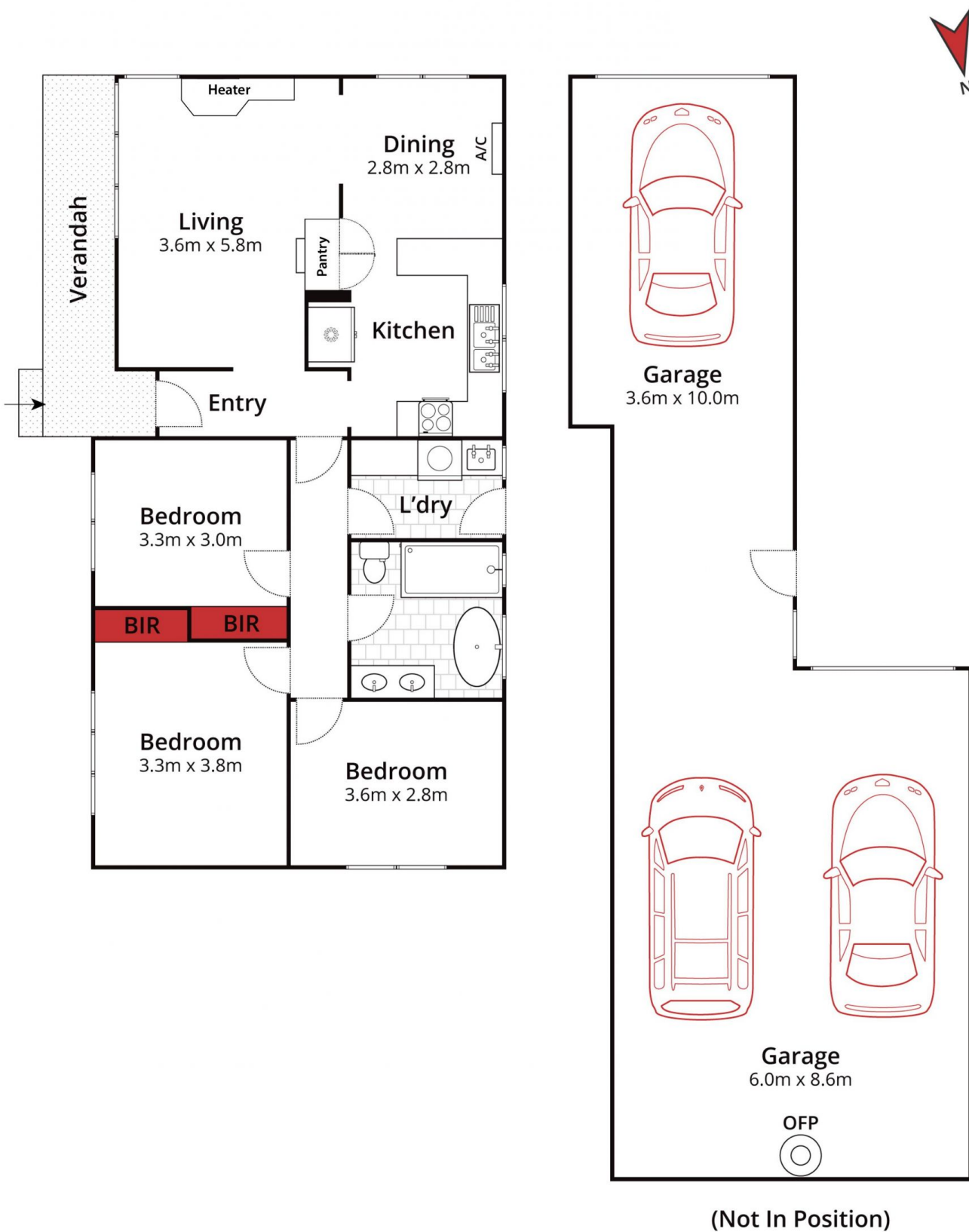

Approx House Area 89m²
Approx Land Area 722m²



Whilst bwrn.com.au has made every attempt to ensure the accuracy of the floor plan contained here, measurements are approximate and no responsibility is taken for any error, omission, or mis-statement. This plan is for illustrative purposes only.

4 Conan Street, Wendouree

Ballarat
Real Estate

