



718 Glenelg Highway Smythes Creek VIC

3 1 1

Located just a quick drive to the Delacombe Town Centre is this impressive property with stunning matured gardens and beautiful trees throughout, lots of shedding and a three bedroom home with huge potential. One of the standout features on this approx 5.43acre (approx) parcel is the private rear paddock with fencing, animal shelters and all year round creek running along the north boundary. The home itself boasts a spacious kitchen that has been thoughtfully renovated with modern fixtures and fittings and large north facing windows. Other features include a main living area with a wood fire and split system, three good sized bedrooms all with BIR. This is a rare opportunity to purchase and won't last long.

Price : \$ 690,000
Land Size : 5.43 Acres
View : <https://www.ballaratrealestate.com.au/sale/vic/ballarat-western-district/smythes-creek/residential/house/7220061>



David Morrison
5331 2233
0438 342 227



Oscar Currell
03 53312233
0499 070 759

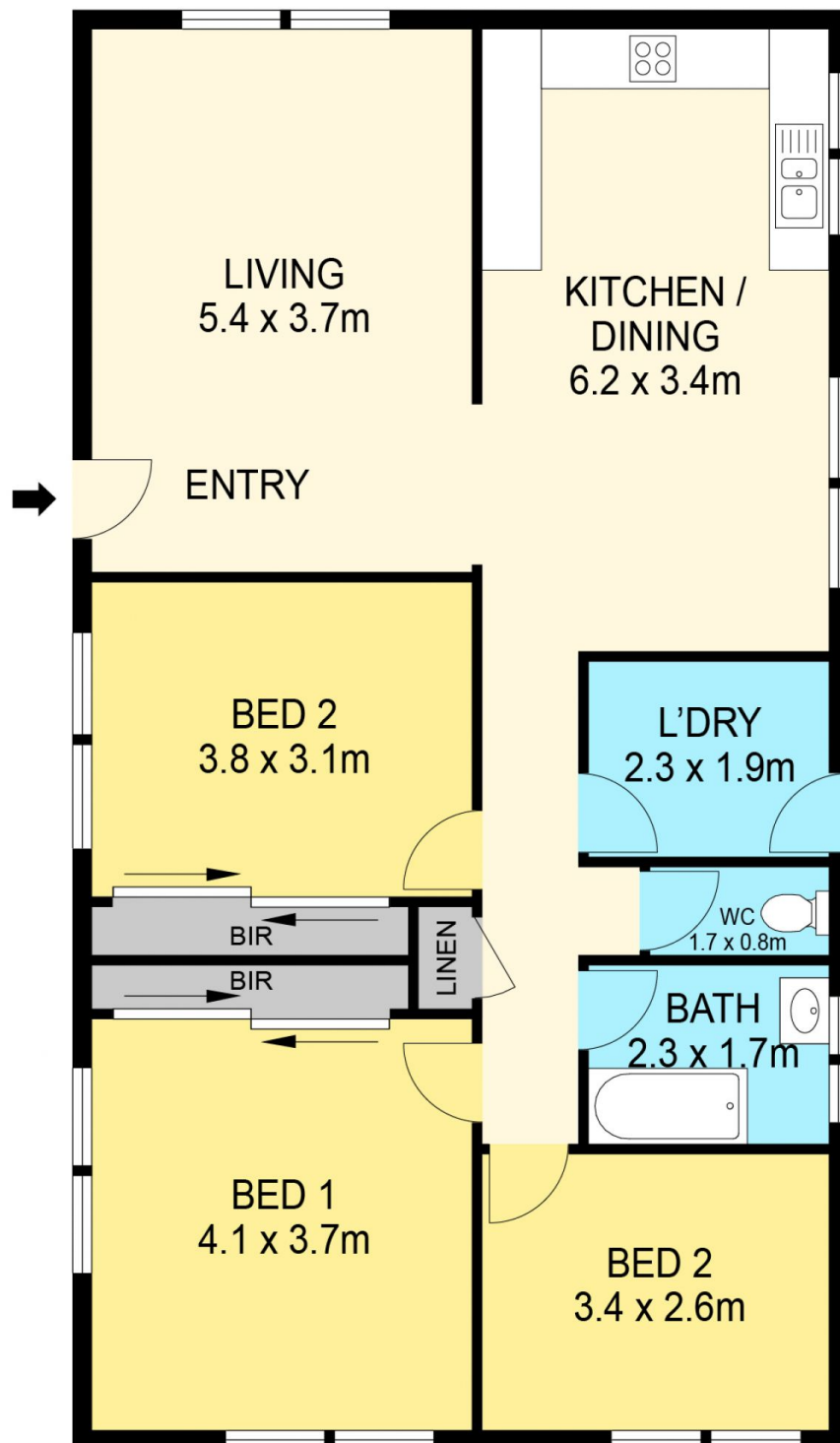

DISCLAIMER

PLANS SHOWN ARE FOR MARKETING PURPOSES ONLY. ALL DIMENSIONS ARE APPROXIMATE AND NOT TO SCALE. THEY ARE SUBJECT TO ERRORS AND INACCURACIES AND NO LIABILITY WILL BE ACCEPTED. INTERESTED PARTIES SHOULD MAKE THEIR OWN INQUIRES.

Ballarat
Real Estate

