



156 Learmonth Road Wendouree VIC

3 1 2

This family home in Wendouree offers three spacious bedrooms, a large central living area, and an open-plan kitchen and dining space. The property boasts a recently updated main bathroom, kitchen, and flooring throughout. It is equipped with gas central heating and a split-system air conditioner in the dining area. Outside, you'll find a sizable fully enclosed backyard, along with a carport and single garage. Conveniently located near Stockland Wendouree, Wendouree Train Station, Lake Wendouree, and with easy access to the Western Highway.

Price : \$ 405,000
Land Size : 715 sqm
View : <https://www.ballaratrealestate.com.au/sale/vic/ballarat-western-district/wendouree/residential/house/8101548>

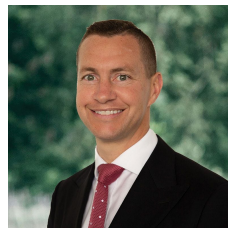

Damian Larkin
03 53312233
0417 088 755



David Morrison
5331 2233
0438 342 227

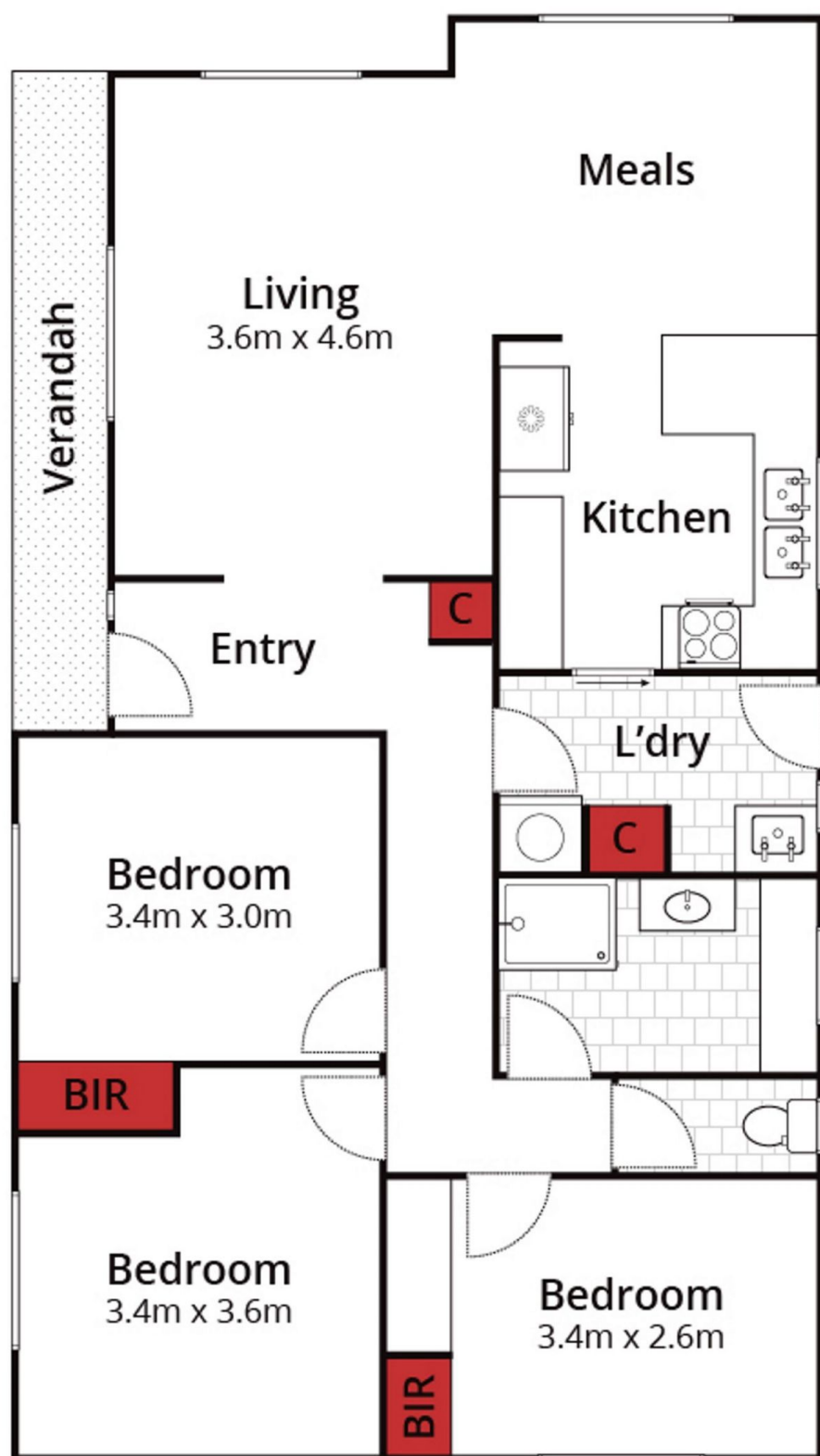

Approx House Area 93m²
 Approx Land Area 715m²

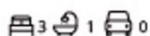

Whilst bwm.com.au has made every attempt to ensure the accuracy of the floor plan contained here, measurements are approximate and no responsibility is taken for any error, omission, or mis-statement. This plan is for illustrative purposes only.

156 Learmonth Road, Wendouree

Ballarat
 Real Estate

