



### 43 Club Crescent Invermay Park VIC

4 2 2

Situated in a quiet court overlooking the par 3 third hole at Midlands Gold Club is this large and well maintained home. The location is so desirable as it is safe, secure and convenient with Northway Shopping Centre just around the corner. This suburb is also positioned well between the Melbourne Freeway and Ballarat CBD with train line to Melbourne. Inside you have a large L-shaped living area that opens up to a generous outdoor entertaining area that faces north and overlooks the well manicured gardens and further to the lush golf course. The functional kitchen has plenty of storage and an attached meals area. The master bedroom has walk in robe and ensuite while all of the other bedrooms have built in storage. The main bathroom has separate shower and bath while there is also a full laundry. Other features include gas central heating, split system, LED I ...

**Price** : \$695,000 - \$750,000  
**Land Size** : 726 sqm  
**View** : <https://www.ballaratrealestate.com.au/sale/vic/ballarat-western-district/invermay-park/residential/house/8105261>



**Dominic Morrison**  
5331 2233  
0409 557 461



**Mason Bourke**  
5331 2233  
0412 374 633

43 Club Crescent Invermay Park

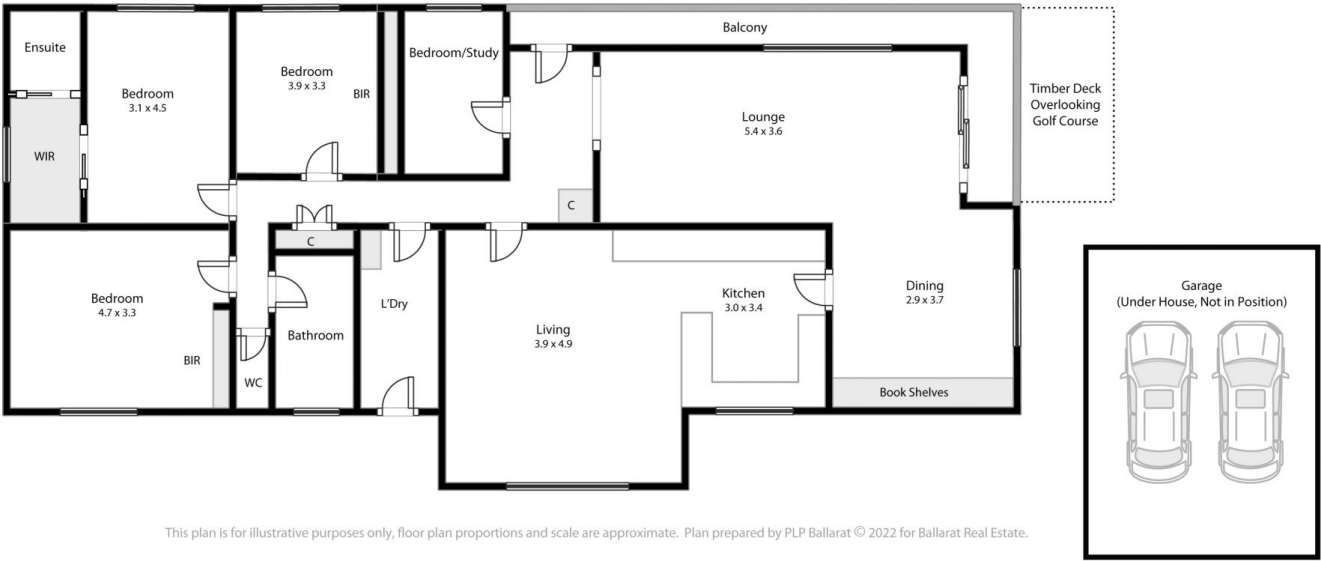

Contact: Dominic Morrison 0409557461